

DRAWINGS FOR PROPOSED IMPROVEMENTS HALL PARK BOAT RAMP PHASE 1 RIVERSIDE, WASHINGTON COUNTY, IOWA

LEGAL DESCRIPTION

17 77 06 LOT B SD PT W1/2 NW1/4

DESIGN STANDARDS AND REFERENCE DRAWINGS

THE PROPOSED IMPROVEMENTS INCLUDED IN THESE DRAWINGS HAVE BEEN DESIGNED IN ACCORDANCE WITH THE CITY OF CEDAR RAPIDS COMPLETE STREET DESIGN STANDARDS OF 2014 AND THE IOWA STATEWIDE URBAN DESIGN AND SPECIFICATIONS (SUDAS), LATEST ADDITION, UNLESS NOTED OTHERWISE ON THE PLANS.

THE FOLLOWING DESIGN EXCEPTIONS ARE REQUIRED: CEDAR RAPIDS SUPPLEMENTAL DOCUMENTS.

THE FOLLOWING SUDAS FIGURES ARE INCLUDED BY REFERENCE:

FIGURE	TITLE
3010.101	TRENCH BEDDING AND BACKFILL ZONES
3010.102	RIGID GRAVITY PIPE TRENCH BEDDING
3010.103	FLEXIBLE GRAVITY PIPE TRENCH BEDDING
4020.211	PIPE CONNECTIONS FOR STORM SEWER
4030.221	RCP APRON SECTION FOOTING
4030.222	CIRCULAR CONCRETE APRONS
9040.102	FILTER BERM AND FILTER SOCK
9040.103	ROLLED EROSION CONTROL PRODUCT (RECP) INSTALLATION ON SLOPES
9040.119	SILT FENCE
9040.110	RIP RAP FOR PIPE OUTLET ONTO FLAT GROUND
9040.120	STABILIZED CONSTRUCTION ENTRANCE

SITE INFORMATION

EXISTING ZONING		
P-1	PUBLIC USE DISTRICT	
AREA CALCULATIONS		
TOTAL LOT SIZE:	120,661 SF (2.77 AC)	
EXISTING:		
OPEN SPACE	120,661 SF (2.77 AC)	100.0%
SETBACKS:		
NONE		

LOCATION MAP

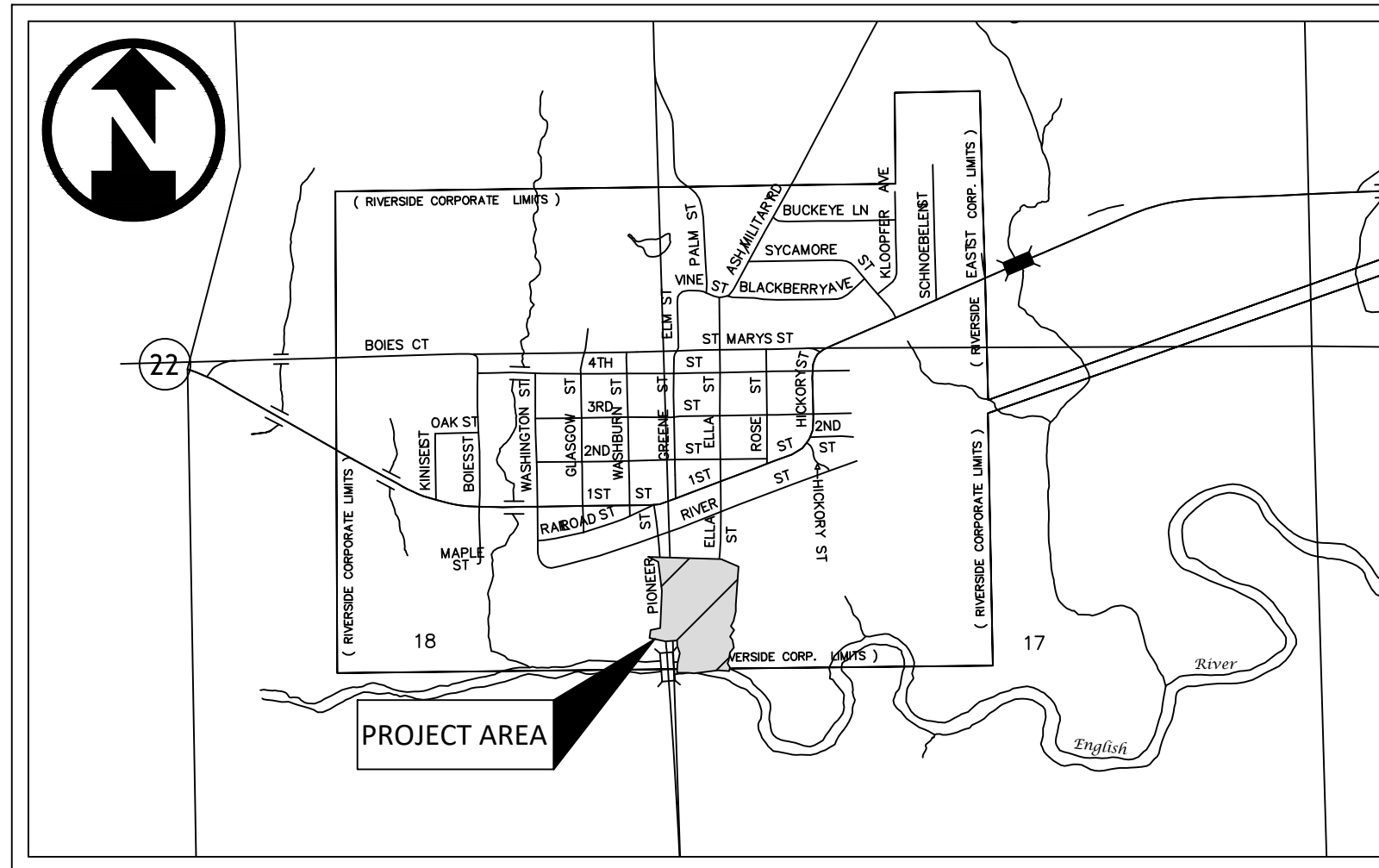

CITY OF CEDAR RAPIDS

SHEET INDEX		REV
C0.00	COVER SHEET	
C1.00	EXISTING CONDITIONS AND REMOVALS PLAN	
C2.00	SITE PLAN	
C3.00	TRAFFIC CONTROL	
C4.00	CONSTRUCTION DETAILS	

PROJECT INFORMATION

CONTACT PERSON:

BRIAN BOELK
AXIOM CONSULTANTS, LLC
60 E COURT STREET, UNIT 3
IOWA CITY, IOWA 52240-3833
PHONE: 319-519-6220
BBOELK@AXIOM-CON.COM

CITY CONTACT

COLE SMITH
CITY ADMINISTRATOR
PHONE: 319-648-3501
CITYADMIN@RIVERSIDEIOWA.GOV



UTILITY CONTACTS

ALLIANT ENERGY
ALLIANT ENERGY FIELD ENGINEER
800-255-4268
LOCATE_IPL@ALLIANTENERGY.COM

PEOPLE SERVICE, INC
STEVE ROBINETTE
319-800-3281
SROBINETTE@PEOPLESERVICE.COM

CITY OF RIVERSIDE
BECKY LAROCHE
319-648-3501
BECKY@CITYOFRIVERSIDEIOWA.COM

MIDAMERICAN-GAS
CARSON HEMPHILL
319-341-4461
CRHEMPHILL@MIDAMERICAN.COM

MEDIACOM
CARL NORTON
319-594-6201
CNORTON@MEDIACOMCC.COM

WINDSTREAM COMMUNICATIONS
LOCATE DESK
800-289-1901
LOCATE.DESK@WINDSTREAM.COM

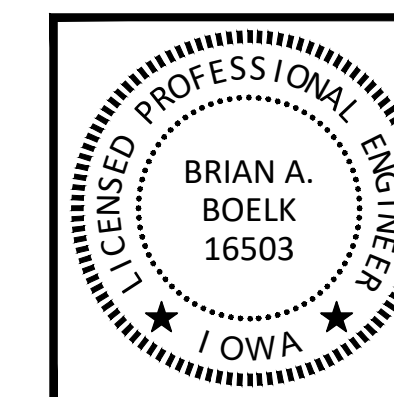

I HEREBY CERTIFY THAT THIS ENGINEERING DOCUMENT WAS PREPARED BY ME OR UNDER MY DIRECT PERSONAL SUPERVISION AND THAT I AM A DULY LICENSED PROFESSIONAL ENGINEER UNDER THE LAWS OF THE STATE OF IOWA.

BRIAN A. BOELK, P.E.
LICENSE NUMBER 16503.

MY LICENSE RENEWAL DATE IS DECEMBER 31, 2024.

PAGES OR SHEETS COVERED BY THIS SEAL: ALL



ENGINEER:

DRAWING LOG
DESCRIPTION OF CHANGES
ISSUED FOR BID

DATE
01-03-2024

REV
1

PROJECT NAME:
RIVERSIDE BOAT RAMP
S PIONEER ST
RIVERSIDE, IA
CLIENT NAME:

SHEET NAME:
COVER SHEET
DESIGNED, DETAILED, AND CHECKED BY:
BETTIS
PROJECT NO.:
230149
SHEET NUMBER:

NOT FOR CONSTRUCTION

C0.00

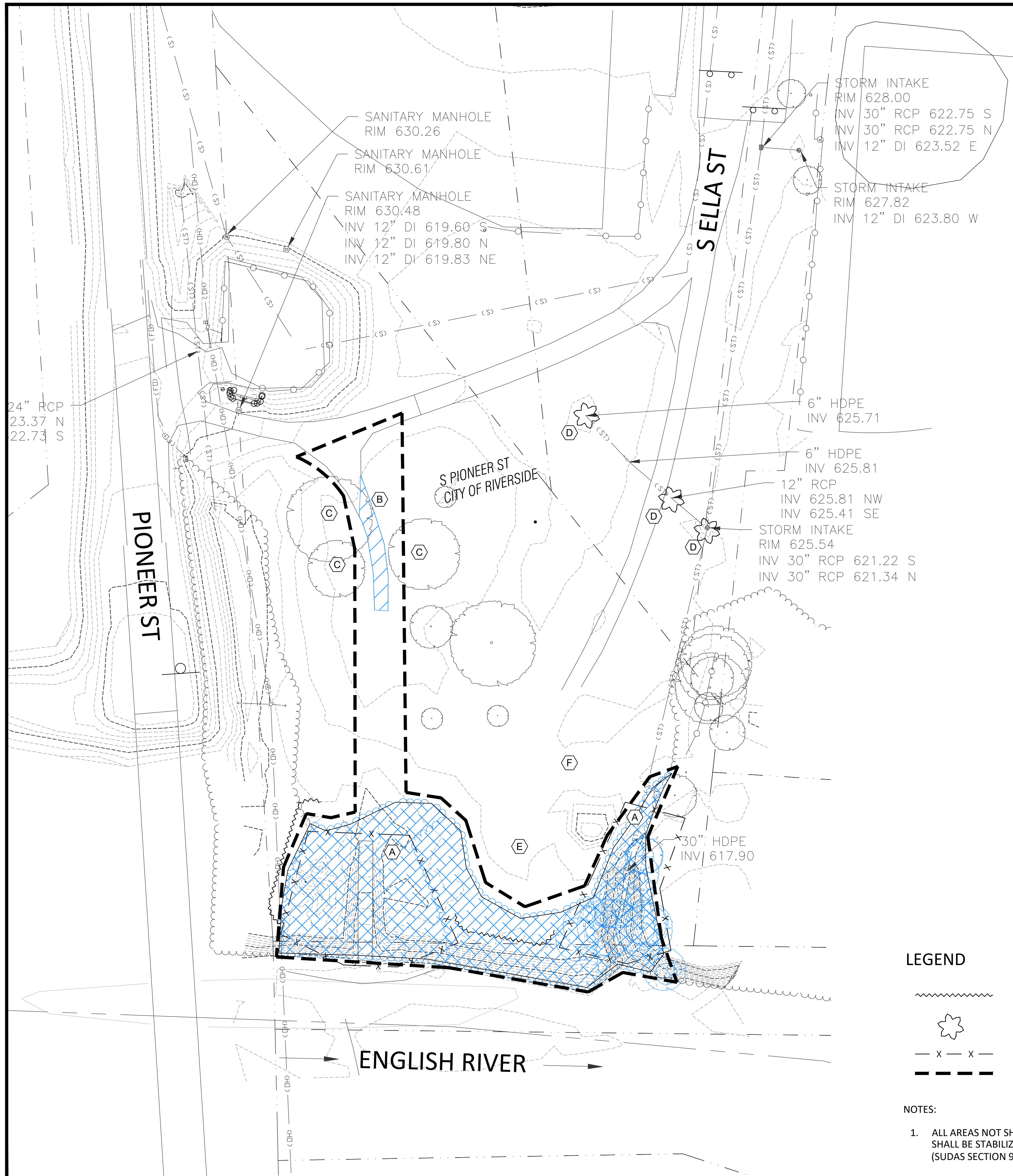

DEMOLITION NOTES:

- (A) AREA TO BE CLEARED OF TREES/SHRUBS
- (B) EXISTING ROCK DRIVE REMOVAL AREA
- (C) PROTECT TREE. SEE DETAIL 1, THIS PAGE.
- (D) INLET PROTECTION
- (E) STOCKPILE AREA
- (F) LAYDOWN AREA

LEGEND

- 9" FILTER SOCK-INSTALL UPON COMPLETION OF FINISH GRADING
- INLET PROTECTION PER IDOT EC-602
- GRADING LIMITS
- DISTURBED AREA

- NOTES:**
1. ALL AREAS NOT SHOWN AS PAVEMENT OR PERMANENT SEEDING SHALL BE STABILIZED WITH TEMPORARY SEEDING (SUDAS SECTION 9010 TYPE 4 MIX)

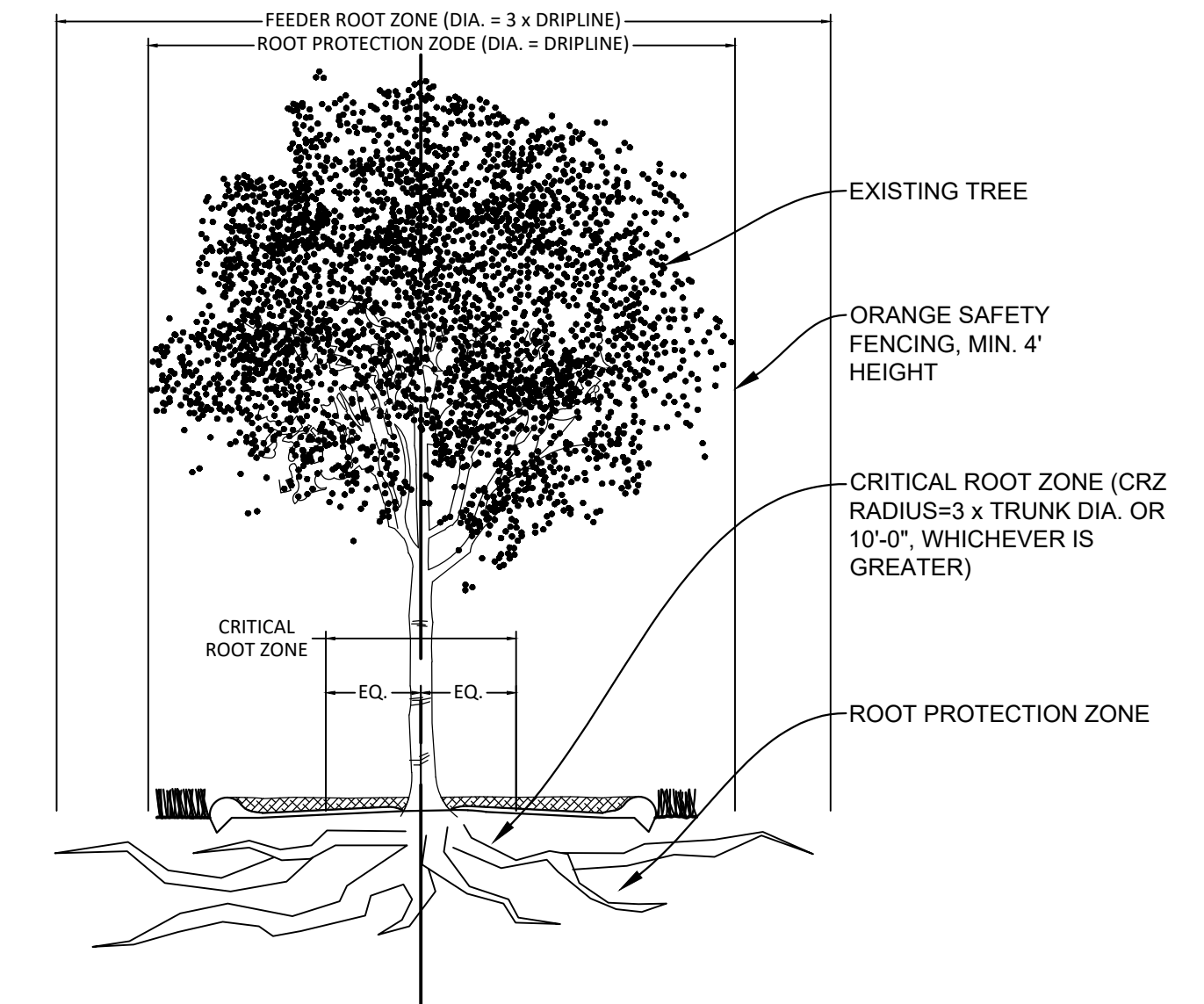

TREE PROTECTION NOTES:

1. MIN. 4'-0" HEIGHT ORANGE SAFETY FENCING SHALL BE PROVIDED AND MAINTAINED AT DRIPLINE.
2. NO DISTURBANCE ALLOWED WITHIN CRITICAL ROOT ZONE (CRZ).
3. OPERATION OF HEAVY EQUIPMENT AND/OR STOCKPILING OF MATERIALS IS PROHIBITED WITHIN THE ROOT PROTECTION ZONE (RPZ).
4. DIAMETER AT BRESTH HEIGHT (DBH) IS MEASURED AT 4'-6" ABOVE GRADE.

TREE PROTECTION
 NTS

1

AXIOM CONSULTANTS
 WWW.AXIOM-CON.COM | (319) 519-6220

ENGINEER:

DATE: 01-08-2024

DRAWING LOG

REV	DESCRIPTION OF CHANGES	ISSUED FOR BID
1		

PROJECT NAME: RIVERSIDE BOAT RAMP
 S PIONEER ST
 RIVERSIDE, IA

CLIENT NAME:

SHEET NAME: EXISTING CONDITIONS AND REMOVALS PLAN

DESIGNED, DETAILED, AND CHECKED BY: BETTIS

PROJECT NO.: 230149

SHEET NUMBER: C1.00

NOT FOR CONSTRUCTION

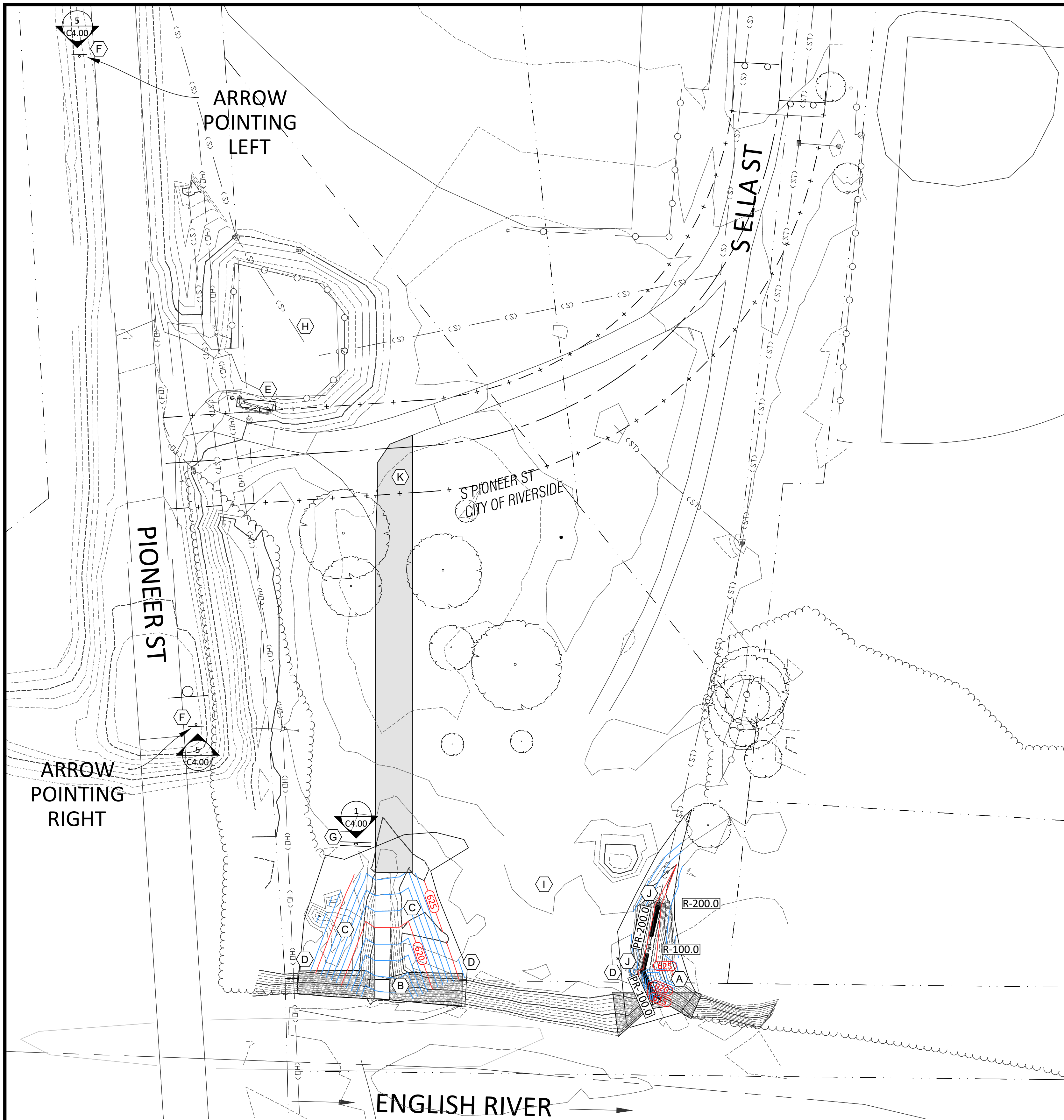

KEYNOTES

- (A) TREE REMOVAL AND GRADING OF SWALE FOR STORM SEWER PIPE OUTLET
- (B) POSSIBLE END OF RAMP FIX OR EXTENSION
- (C) TREE REMOVAL AND GRADING TO ALLOW FOR FUTURE RAMP WIDENING
- (D) EROSION CONTROL ALONG ENGLISH RIVER AND OR CHANNEL.
- (E) PROTECT EXISTING CITY OF RIVERSIDE SIGN
- (F) WAY MARKING SIGN
- (G) RIVER CORRIDOR SIGNAGE
- (H) EXISTING CITY LIFT STATION
- (I) FUTURE PAVILION AND OPEN SPACE SITE AMENITIES
- (J) STORM STRUCTURE
- (K) ROCKED PAVEMENT

STORM SEWER STRUCTURES				
STRUCTURE ID	TYPE	RIM / FG	INFLOW PIPE IE	OUTFLOW PIPE IE
36" FES W/ TOE WALL	FES	619.22		36" IE: 615.71 NW
100.0	SW-401 60" DIA.	624.32	36" IE: 616.00 SE	36" IE: 616.10 N
200.0	SW-401 60" DIA.	624.72	36" IE: 617.00 S	

STORM SEWER PIPE TABLE								
PIPE ID	STRUCTURE US	STRUCTURE DS	INVERT US	INVERT DS	LENGTH (FEET)	SLOPE	SIZE (IN)	MATERIAL
100.0	36" FES W/ TOE WALL	100.0	615.71	616.00	15	-2.00%	36	HDPE
200.0	100.0	200.0	616.10	617.00	45	-2.00%	36	HDPE

NOT FOR CONSTRUCTION

SHEET NO.: 230149

SHEET NUMBER: 230149

DESIGNED, DETAILED, AND CHECKED BY: BETTIS

CLIENT NAME: RIVERSIDE, IA

PROJECT NAME: RIVERSIDE BOAT RAMP
S PIONEER ST
RIVERSIDE, IA

DRAWING LOG

REV	DESCRIPTION OF CHANGES	DATE
1	ISSUED FOR BID	01-08-2024

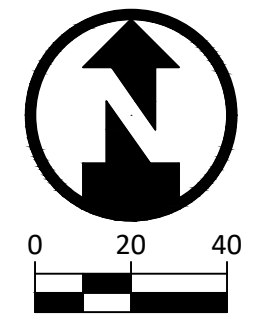

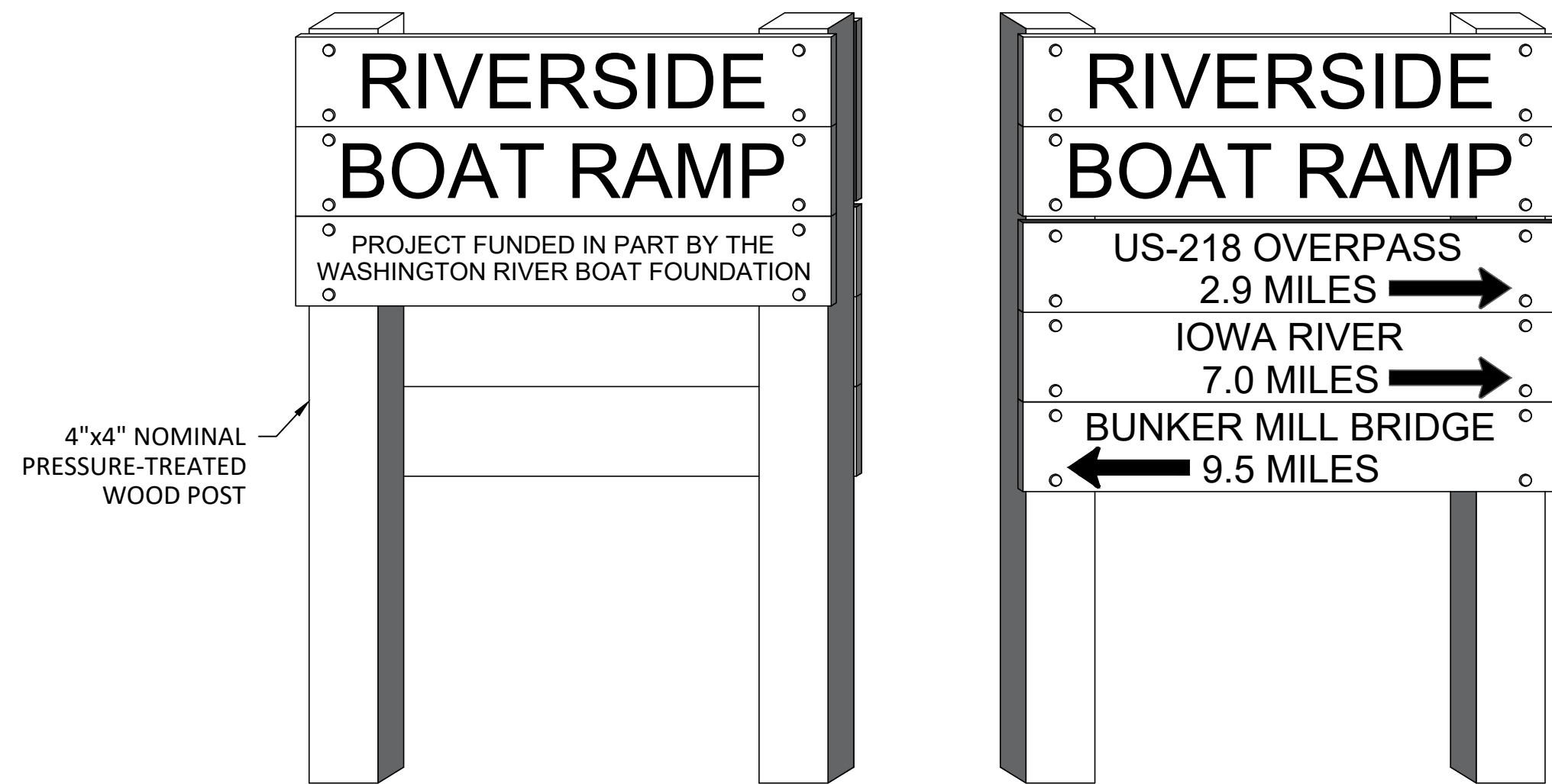

BOAT RAMP SIGN

FRONT(LEFT) & BACK(RIGHT)
NTS

1

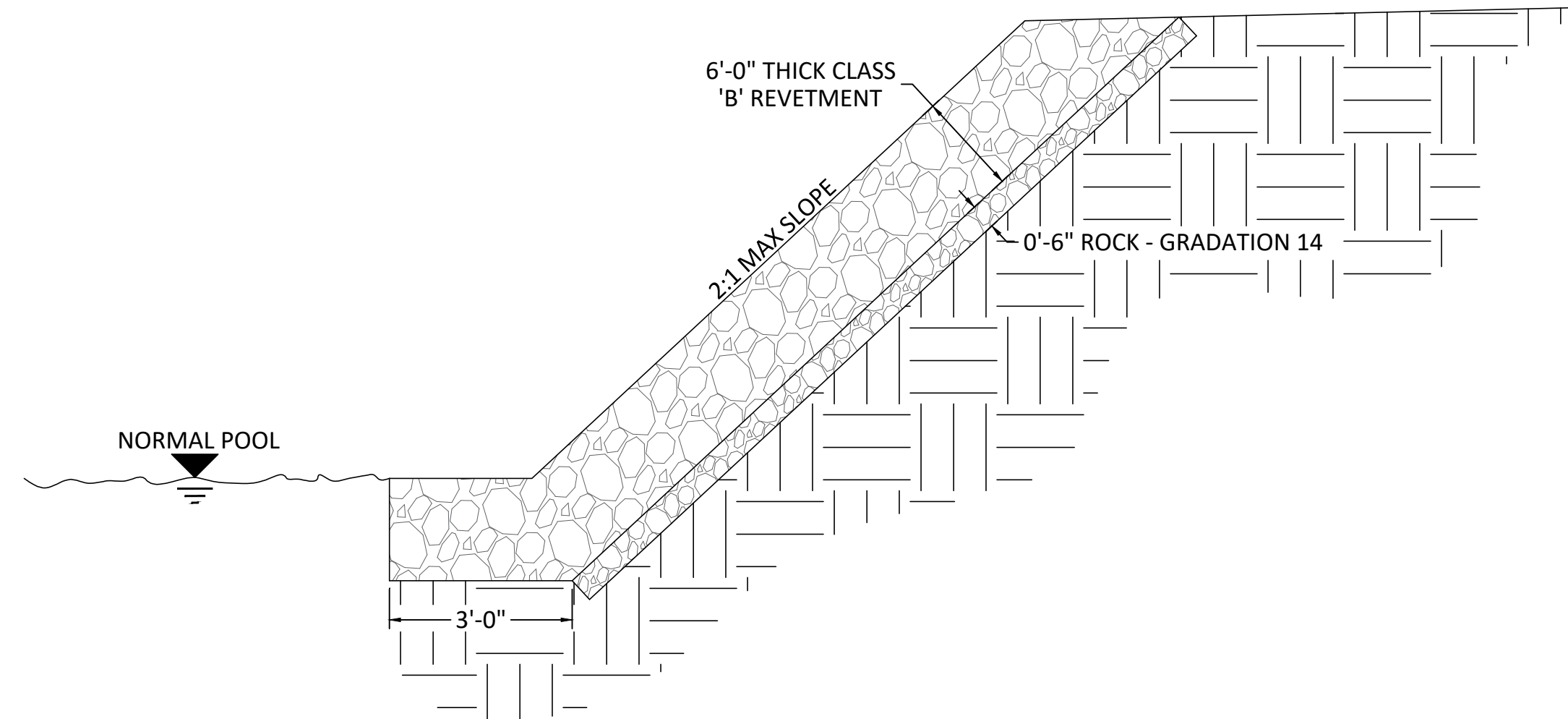

EROSION CONTROL REVETMENT

NTS

2

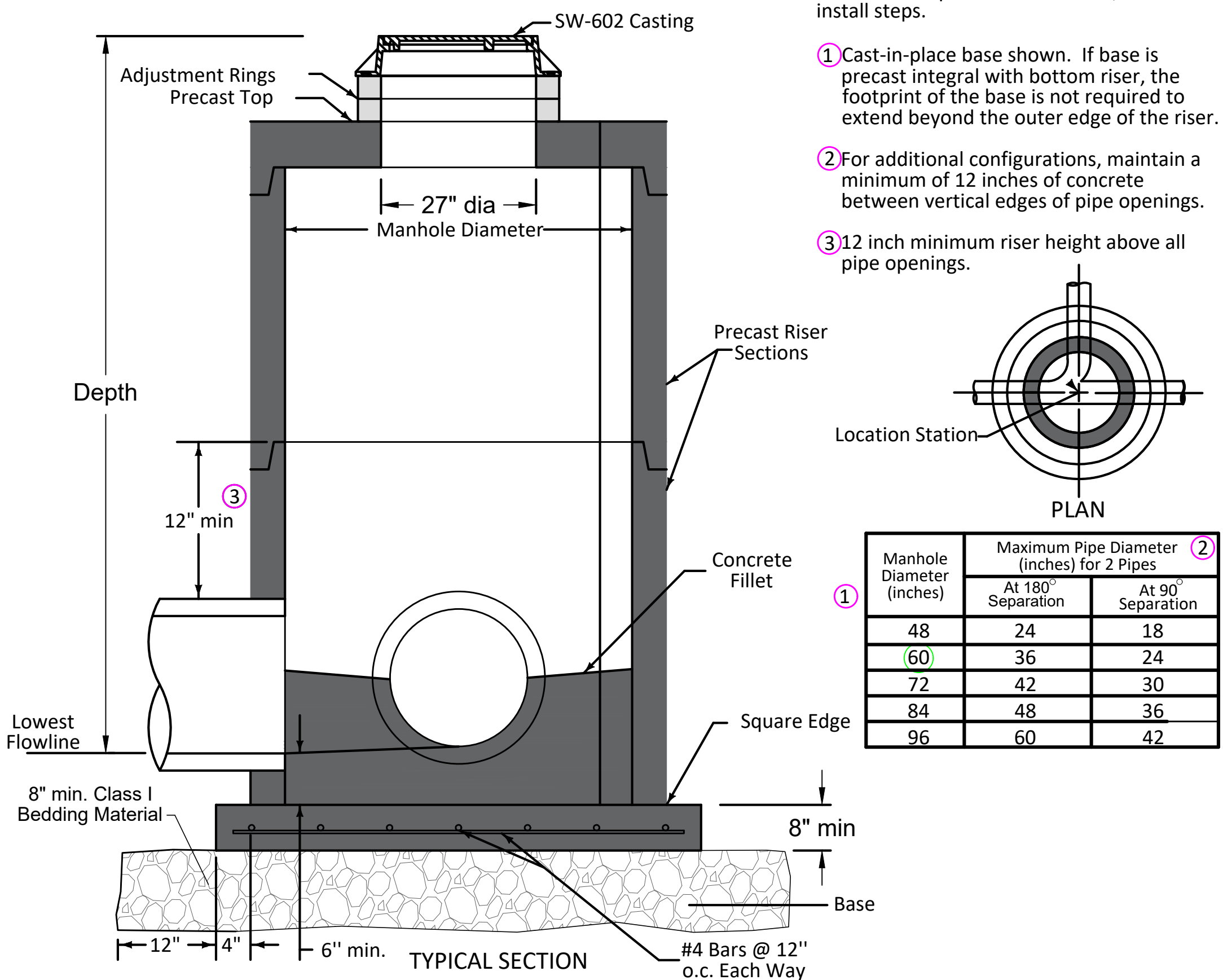

- ① Cast-in-place base shown. If base is precast integral with bottom riser, the footprint of the base is not required to extend beyond the outer edge of the riser.
- ② For additional configurations, maintain a minimum of 12 inches of concrete between vertical edges of pipe openings.
- ③ 12 inch minimum riser height above all pipe openings.

- ①
- ②
- ③

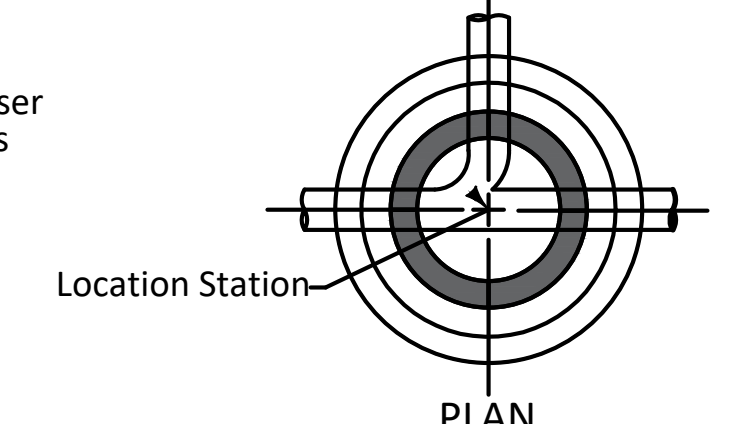

Manhole Diameter (inches)	Maximum Pipe Diameter (inches) for 2 Pipes	
	At 180° Separation	At 90° Separation
48	24	18
60	36	24
72	42	30
84	48	36
96	60	42

CIRCULAR STORM SEWER MANHOLE

SW-401
NTS

3

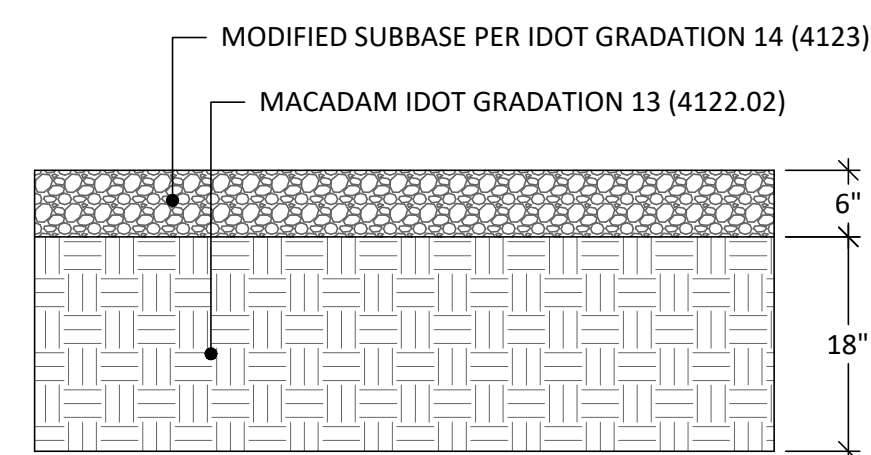

ROCKED PAVEMENT SECTION

NTS

4

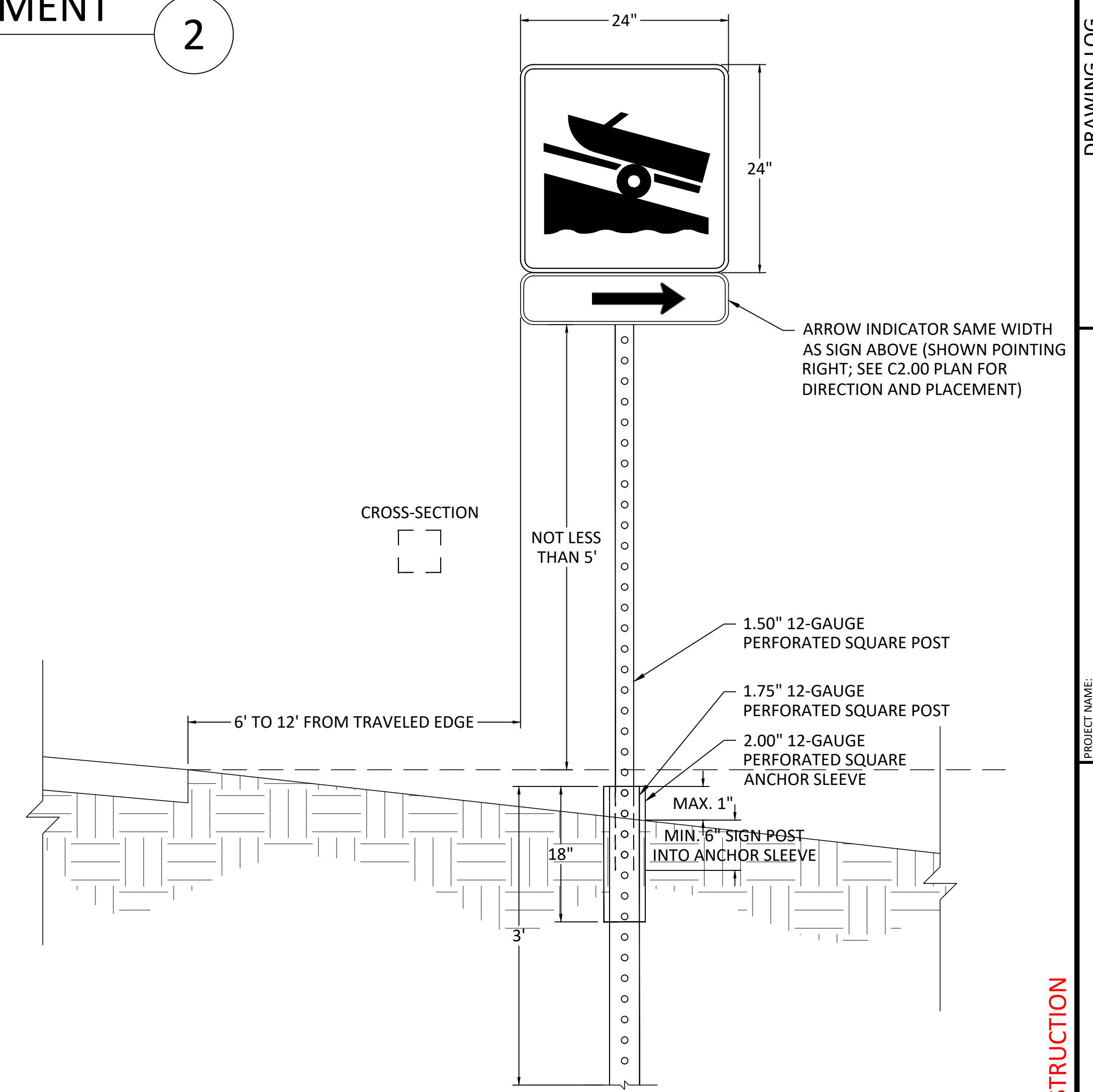

24"x24" BREAKAWAY SIGN DETAIL

MUTCD RS-054
NTS

5

ENGINEER:

REV	DATE	DESCRIPTION OF CHANGES
1	01-08-2024	ISSUED FOR BID

DRAWING LOG

REV	DATE	DESCRIPTION OF CHANGES
1	01-08-2024	ISSUED FOR BID

PROJECT NAME:
RIVERSIDE BOAT RAMP
S PIONEER ST
RIVERSIDE, IA
CLIENT NAME:

SHEET NAME:
CONSTRUCTION DETAILS
DESIGNED, DETAILED, AND CHECKED BY:
BETTIS
PROJECT NO.:
230149
SHEET NUMBER:

NOT FOR CONSTRUCTION